

# AJC Chucking System

## Description:

The ultimate in quick change for 3 jaw chuck machining

## Applications:

High production chucking jobs... especially suited for automotive "family of parts" work

## Key Features:

- Unattended changeover
  - Via robotic or gantry loading system and vision equipment
  - Changes over all three jaws as a complete unit
    - Increased part processing flexibility in JIT, large volume lot production
  - High clamping accuracy
  - Choose from five different system sizes



## **Large lot turning applications over a family of parts? JIT production schedules increasing the number of changeovers? Wanting to automate chuck change?**

Our AJC Chucking System now gives you the ultimate in quick chuck changeover... and it's a step above other quick jaw change systems being offered today — those that require each jaw to be changed individually.

LMC's AJC Chucking system replaces the entire face of the chuck as a complete unit via unattended robotic or gantry loading systems. (Can be replaced by hand quickly, too.)

When the next family of parts is to be turned, a separate plate containing the top jaws can be replaced and a new plate chosen from a storage rack—rapidly changing out the entire chuck face. When maximizing productivity is the name

of the game, the AJC System and the use of robotic loading and part vision systems will help you realize 100% unattended job changeover.

Offered in five different system sizes...configurations include:

- A6, A8 and A11 spindle mounts
- 8", 10", 12", 15" and 18" chuck sizes
- 34, 35, 46 and 72 mm thru-hole configurations

High quality...rugged...productive... and internationally designed/American-built and supported. All found in this system, as well as other LMC Workholding systems — check out our line's breadth.

***LMC Workholding... power for today's demanding machining applications.***

# AJC Chucking System

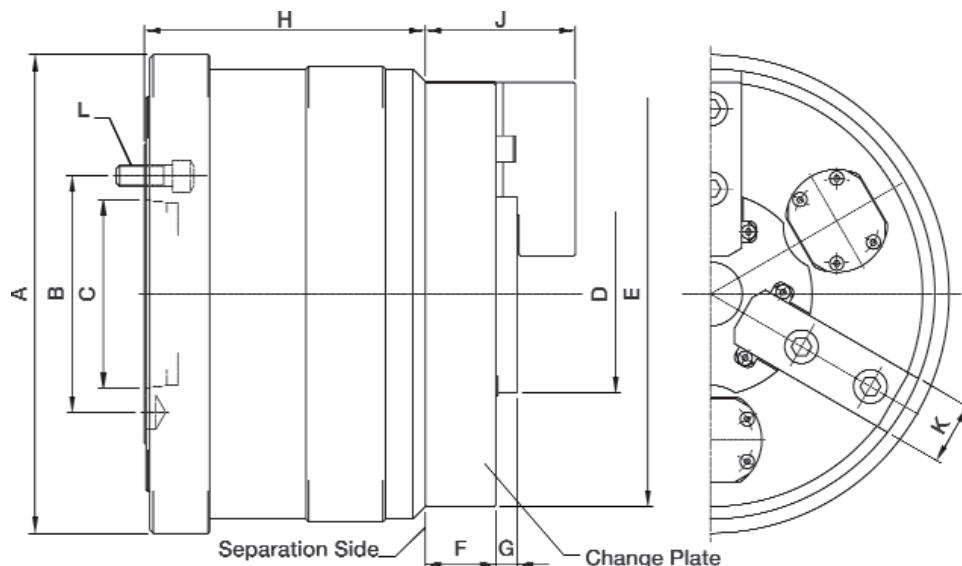

The LMC Workholding line includes:



- Hydraulic power chucks, cylinders and wheel chucks



- Atling steady rests



- Neidlein face drivers, as well as live and dead centers

## Specifications

	AJC A6-8-34	AJC A8-10-35	ACJ A8-12-46	AJC A11-15-72	AJC A11-18-72
Max Rotation Speed (rpm)	3600	3500	2500	1250	900
Jaw Stroke (dia, mm)	7.6	9.0	9.0	13.3	13.3
Gripping Force (KN)	58.8	85.3	94.1	114.7	147.1
Max. Draw Pull (KN)	25.5	37.3	41.2	47.6	60
Weight (KG)	40	67	113	224	244
GD2 Value (N-m)	10.8	21.7	53.9	165.7	282.2
<b>PART OF CHUCK</b>					
Sifter Stroke (mm)	17	20	20	30	30
Chuck Body Weight (Kg)	32	55	92	166	64
<b>PART OF FINGER</b>					
Stroke (mm)	32	31	32	37	37
Finger Clamping Force (kN)	29.4	42.6	42.6	54.9	54.9
Weight of Change Plate (Kg)	29.4	42.6	42.6	54.9	54.9
A (dia, mm)	210	270	305	381	457
B (dia, mm)	104.8	171.4	171.4	235	235
C (spindle mount type)	A-6	A-8	A-8	A-11	A-11
D (dia, mm)	80	110	130	-	-
E (dia, mm)	220	240	290	381	457
F (mm)	30	40	46	60	60
G (mm)	12	12	12	-	-
H (mm)	163	159	183	220	220
J (mm)	63.4	85	96	125	125
K (mm)	30	35	40	60	60
L	M12	M16	M16	M20	M20

[www.LMCworkholding.com](http://www.LMCworkholding.com)

LMC Workholding  
 P.O. Box 7006 • 1200 West Linden Avenue  
 Logansport, Indiana 46947-7006  
 Phone 574-735-0225 • Fax 574-722-6559  
 E-mail: info@LMCworkholding.com

