

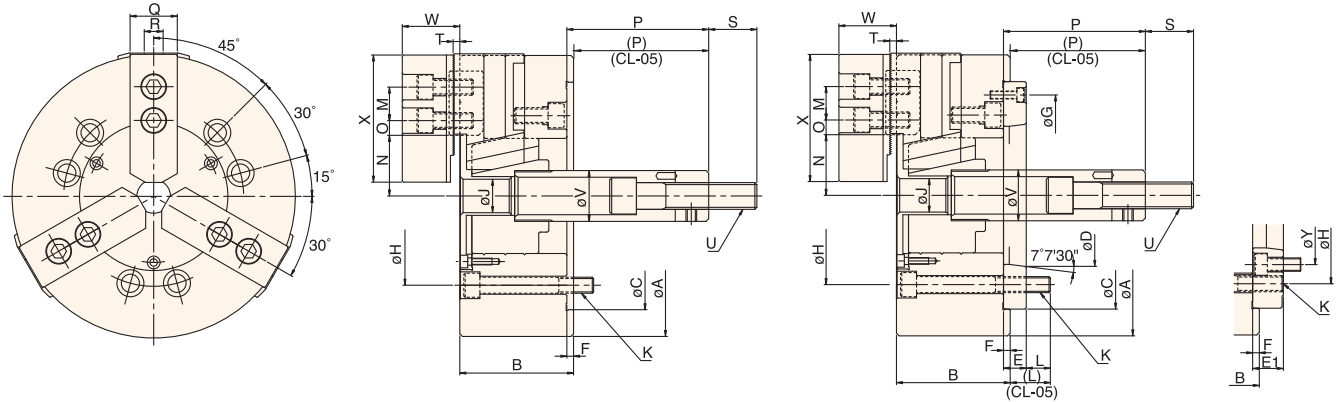

3-JAW SOLID POWER CHUCKS

■ DIMENSIONS



■ SPECIFICATIONS

UNIT:mm

MODEL / SPEC.	Nose Of Spindle	A	B	C (h6)	D	E	E1	F	G	H	J	K	L	M	N max.
CL-05	A _z -4	135	55	80	63.513	--	--	7	--	100	--	3-M8x1.25P	14	14	30.4
CL-06	A _z -5	165	74	140	82.563	15	--	5	116	104.8	21	6-M10x1.5P	14	20	37.8
CL-08	A _z -6(A _z -5)	210	85	170	106.375	17	23	5	150	133.4	25	6-M12x1.75P	18	25	46.3
CL-10	A _z -8(A _z -6)	254	89	220	139.719	18	28	5	190	171.4	34	6-M16x2P	25	30	51.4
CL-12	A _z -8	304	106	220	139.719	18	--	6	190	171.4	34	6-M16x2P	25	30	60.7
CL-15	A _z -11	381	114	300	196.869	22	--	6	260	235	--	6-M20x2.5P	32	43	77.5
CL-18	A _z -11	450	114	300	196.869	22	--	6	260	235	--	6-M20x2.5P	32	43	108

MODEL / SPEC.	N min.	O max.	O min.	P max.	P min.	Q	R	S	T	U	V	W	X	Y	Plunger Stroke (mm)	Jaw Stroke [Diameter] (mm)
CL-05	27.2	17	7	9	-6	25	10	35	2	M12x1.75P	28	31	62	-	15	6.4
CL-06	33.25	18	7.5	101.5	81.5	31	12	36	4	M16x2P	34	39	73	-	20	8.5
CL-08	41.9	22.5	9	127	106	35	14	36	5	M20x2.5P	38	42	95	104.8	21	8.8
CL-10	47	37.5	10.5	158	133	40	16	36	5	M20x2.5P	45	46	110	133.4	25	8.8
CL-12	55.45	47	11	163	133	50	18	36	5	M20x2.5P	50	54	130	-	30	10.5
CL-15	69.5	50.25	23.25	104	69	62	25.5	55	2	M30x3.5P	60	63	165	-	35	16
CL-18	100	49.5	25.5	92	57	62	25.5	55	2	M30x3.5P	60	63	165	-	35	16

MODEL / SPEC.	Max.Speed r.p.m.(min ⁻¹)	Max. Pull Force kgf (KN)	Max. Gripping Force kgf (KN)	Max. Hydr. Pressure kgf/cm ² (Mpa)	Weight (kg)	Matching Cylinder	Gripping Range
CL-05	5500	800 (7.8)	2450 (24)	22 (2.2)	6	L0815	ø8~ø135
CL-06	5000	1730 (17)	5200 (51)	27 (2.6)	11.4	L1020	ø18~ø165
CL-08	4600	2440 (24)	7440 (73)	25 (2.5)	21.9	L1225	ø12~ø210
CL-10	4000	2850 (28)	10810 (106)	29 (2.8)	33.4	L1225	ø16~ø254
CL-12	3200	4080 (40)	15500 (152)	29 (2.8)	58.5	L1530	ø18~ø304
CL-15	2800	8260 (81)	25290 (248)	32.5 (3.2)	100.6	L2035	ø68~ø381
CL-18	2500	8260 (81)	25290 (248)	32.5 (3.2)		L2035	ø85~ø450