

SUPER THIN SQUARE CHUCKS

Patent Protected

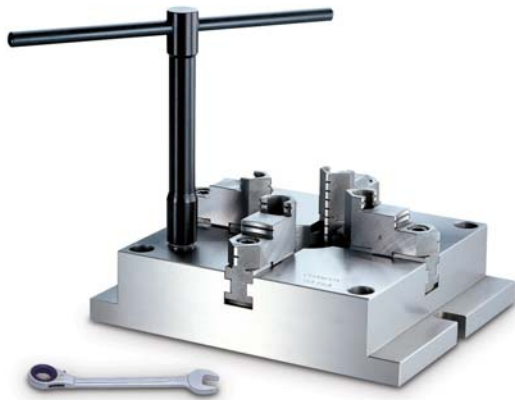

OPERATION EXAMPLE



MC SQUARE CHUCKS

1. MC chucks are precisely ground, the tolerances of W,X,Y,Z among chucks are within 0.05mm.
2. Soft jaws can be used alternatively for machining special shaped work pieces, to substitute for designing and making a lot of jigs for this purpose.
3. The repetitive gripping accuracy with the hard jaws are within 0.02mm.
4. Parallel gripping accuracy with hard jaws can be controlled within 0.05mm after aligning sides of chucks.

Diagram of square chucks at W-X-Y-Z points.

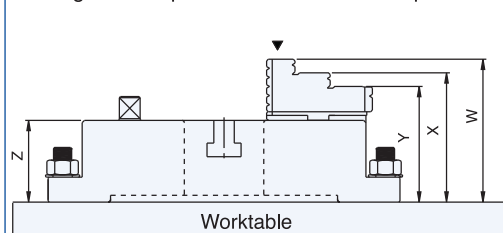

DIMENSIONS

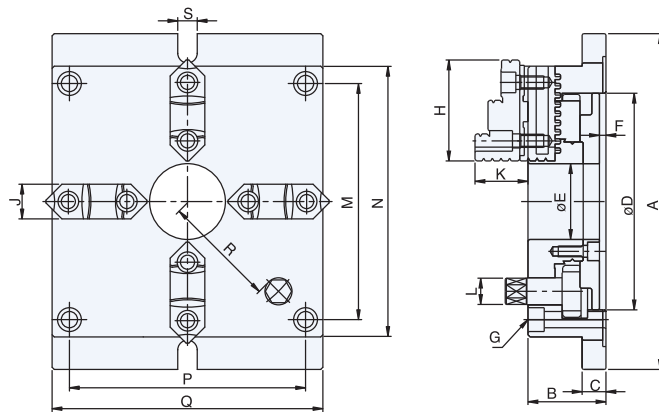

SPECIFICATIONS

UNIT:mm

MODEL / SPEC.	A	B	C	D	E	F	G	H	J	K	L
MC-06	215	57	18	130	40	5.5	4-M10x1.5P	68	26	39	14
MC-08	250	65	20	160	55	6	4-M12x1.75P	82	28	43	17
MC-10	310	72	22	200	70	6	4-M14x2P	93	32	50	21
MC-12	380	85	25	260	100	7	4-M16x2P	118	40	56	23

MODEL / SPEC.	M	N	P	Q	R	S	Max.Gripping Diameter		Weight (kg)
							O.D. Clamping (mm)	I.D. Clamping (mm)	
MC-06	144	165	144	165	66	18	ø4-ø128	ø55-ø128	11.4
MC-08	174	200	174	200	83	18	ø5-ø162	ø62-ø162	18.6
MC-10	218	250	218	250	104	18	ø6-ø200	ø72-ø200	31.6
MC-12	274	310	274	310	135	22	ø10-ø265	ø90-ø265	56.6