

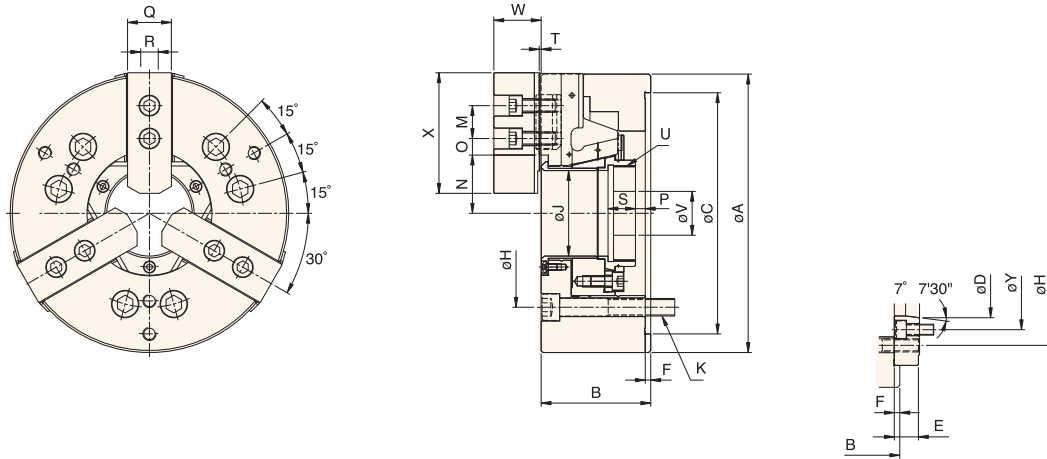

## LARGE THROUGH HOLE 3-JAW HIGH SPEED POWER CHUCK

### ■ DIMENSIONS



### ■ SPECIFICATIONS

UNIT:mm

MODEL / SPEC.	Nose Of Spindle	A	B	C (h6)	D	E	F	H	J	K	M	N max.	N min.
OPB-206	A <sub>2</sub> -5	170	81	140	ø82.563	20	5	PCDø122	52	6-M10x1.5P	20	36.35	33.6
OPB-208	A <sub>2</sub> -6	215	91	170	ø106.375	22	5	PCDø150	66	6-M12x1.75P	25	46.6	42.9
OPB-210	A <sub>2</sub> -8	254	100	220	ø139.719	30	5	PCDø180	81	6-M16x2P	30	54.6	50.1

MODEL / SPEC.	O max.	O min.	P max.	P min.	Q	R	S	T	U	V	W	X	Y	Thru-Hole [Diameter] (mm)	Plunger Stroke (mm)	Jaw Stroke [Diameter] (mm)
OPB-206	21.1	9.1	6.9	-5.1	31	12	23	2	M60x2P	20	37.5	73	104.8	52	12	5.5
OPB-208	26.6	11.6	9.9	-6.1	35	14	25	2	M75x2P	30	39.5	80	133.4	66	16	7.4
OPB-210	33.1	13.6	8.9	-10.1	40	16	25	2	M90x2P	40	43	110	171.4	81	19	8.8

MODEL / SPEC.	Max.Speed r.p.m.(min <sup>-1</sup> )	Max. Pull Force kgf (KN)	Max. Gripping Force kgf (KN)	Max. Hydr. Pressure kgf/cm <sup>2</sup> (Mpa)	Weight (kg)	Matching Cylinder	Gripping Range
OPB-206	6000	2200 (21.5)	5900 (58)	21 (2.0)	12.3	P1452S	ø13~ø170
OPB-208	5000	3400 (33)	8800 (86)	26 (2.5)	21.7	P1666S	ø47~ø215
OPB-210	4200	4300 (42)	11100 (109)	29 (2.8)	33.6	P1881S	ø34~ø254