

## 3-JAW POWERFUL TYPE SCROLL CHUCKS

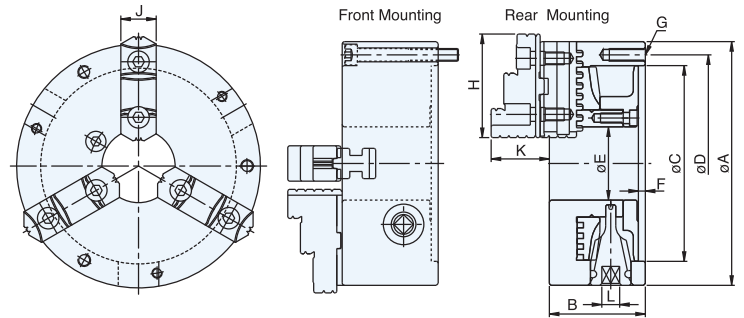

### ■ DIMENSIONS



### ■ SPECIFICATIONS

UNIT:mm

MODEL / SPEC.	A	B	C	D	E	F	G	H	J	K	L	Max.Speed r.p.m.(min <sup>-1</sup> )	Max. Gripping Diameter		Weight (kg)
													O.D.Clamping	I.D.Clamping	
SK-06	167	66	130	147	45	5	3-M10x1.5P	68	26	39	10	2000	ø8-ø160	ø55-ø150	8.6
SK-07	193	76	155	172	58	5	3-M10x1.5P	82	28	43	11	2000	ø8-ø180	ø62-ø170	12.8
SK-08	203	76	160	176	58	5	3-M10x1.5P	82	28	43	11	2000	ø8-ø180	ø62-ø170	14.1
SK-09	233	84	190	210	70	5.5	3-M12x1.75P	93	32	50	12	2000	ø11-ø220	ø70-ø210	20.4
SK-10	273	86	230	250	89	5.5	3-M12x1.75P	93	32	50	12	1800	ø12-ø260	ø80-ø250	26.7
SK-12	310	96	260	285	105	7	3-M12x1.75P	118	40	56	14	1800	ø15-ø300	ø90-ø290	39.3
SK-16	405	122	345	375	160	8	6-M14x2P	150	45	75.5	15	1500	ø30-ø400	ø110-ø380	82.3

## 4-JAW POWERFUL TYPE SCROLL CHUCKS



### ■ DIMENSIONS

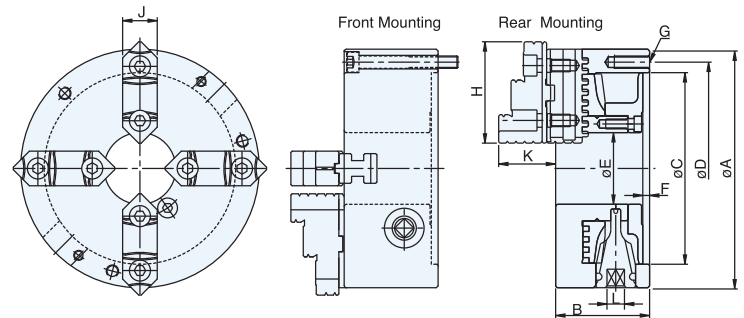

### ■ SPECIFICATIONS

UNIT:mm

MODEL / SPEC.	A	B	C	D	E	F	G	H	J	K	L	Max.Speed r.p.m.(min <sup>-1</sup> )	Max. Gripping Diameter		Weight (kg)
													O.D.Clamping	I.D.Clamping	
PSK-07	193	76	155	172	58	5	3-M10x1.5P	82	28	43	11	2000	ø8-ø180	ø62-ø170	12.7
PSK-09	233	84	190	210	70	5.5	3-M12x1.75P	93	32	50	12	2000	ø11-ø220	ø70-ø210	20.8
PSK-12	310	96	260	285	105	7	3-M12x1.75P	118	40	56	14	1800	ø15-ø300	ø90-ø290	43
PSK-16	405	122	345	375	160	8	6-M14x2P	150	45	75.5	15	1500	ø30-ø400	ø110-ø380	86.7