



3-JAW SUPER PRECISION AIR CHUCKS



Superior Repeatability of 1 μ m.

DIMENSIONS

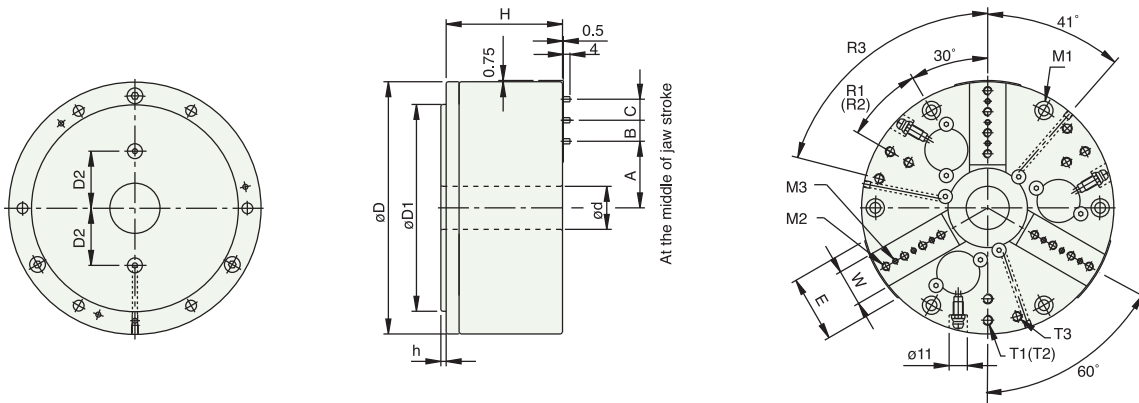

SPECIFICATIONS

UNIT:mm

MODEL / SPEC.	A	B	C	D	E	D1	d (H7)	D2
TK-04	20.75	12.7	12.7	101.6	30	82.55	18	25
TK-06	39.75	12.7	12.7	152.4	40	124.97	26	34.5
TK-08	65.75	25.4	--	203.2	45	167.64	50	50

MODEL / SPEC.	H	h	W	M1	M2
TK-04	70.3	3.2	16	6-M5x0.8P(PCD ϕ 88.9)	6-M5x0.8P
TK-06	70.3	3.2	22	6-M6x1P(PCD ϕ 135.89)	12-M5x0.8P
TK-08	99.5	7.0	25	6-M10x1.5P(PCD ϕ 182.88)	6-M10x1.5P

MODEL / SPEC.	M3	T1	T2
TK-04	9- ϕ 3.18	3-M5x0.8P(PCD ϕ 88.9)	--
TK-06	9- ϕ 3.18	3-M6x1P(PCD ϕ 135.89)	3-M6x1P(PCD ϕ 110)
TK-08	6- ϕ 6.36	3-M8x1.25P(PCD ϕ 182.88)	3-M8x1.25P(PCD ϕ 150)

MODEL / SPEC.	T3	R1	R2	R3	Jaw T.I.R.	Jaw Stroke [Diameter] (mm)
TK-04	--	30°	--	--	0.001	3
TK-06	3-M6x1P(PCD ϕ 135.89)	30°	30°	45°	0.001	3
TK-08	3-M8x1.25P(PCD ϕ 100)	30°	30°	30°	0.001	3

MODEL / SPEC.	Repeatability	Gripping Force At Air Pressure 7kgf/cm ² (0.7Mpa) kgf	Max.Speed r.p.m(min ⁻¹)	Weight (kg)
TK-04	0.001	310 (3.1)	4500	4.4
TK-06	0.001	790 (7.8)	4500	9.8
TK-08	0.001	1450 (14.3)	4000	26.3

coaxiality and repeatability of 1 μ m.

3.Precise soft jaw positioning:

It's easy to remount soft jaw to the correct position with dowel pins on it.

4.High gripping precision brings better quality and efficiency.

Good coaxiality and repeatability of gripping are able to achieve the accuracy of 1 μ m, machining processes can be simplified or shortened to make high precision machining with high efficiency come true.